

MODEL	RATED TORQUE @ STD. AIR GAP		BREAKAWAY TORQUE		MAX RPM
MDC 12	12.2 Nm	108 Lb-in	13.6 Nm	120 Lb-in	9,000

REVISIONS			
REV.	ECN.	DESCRIPTION	DATE

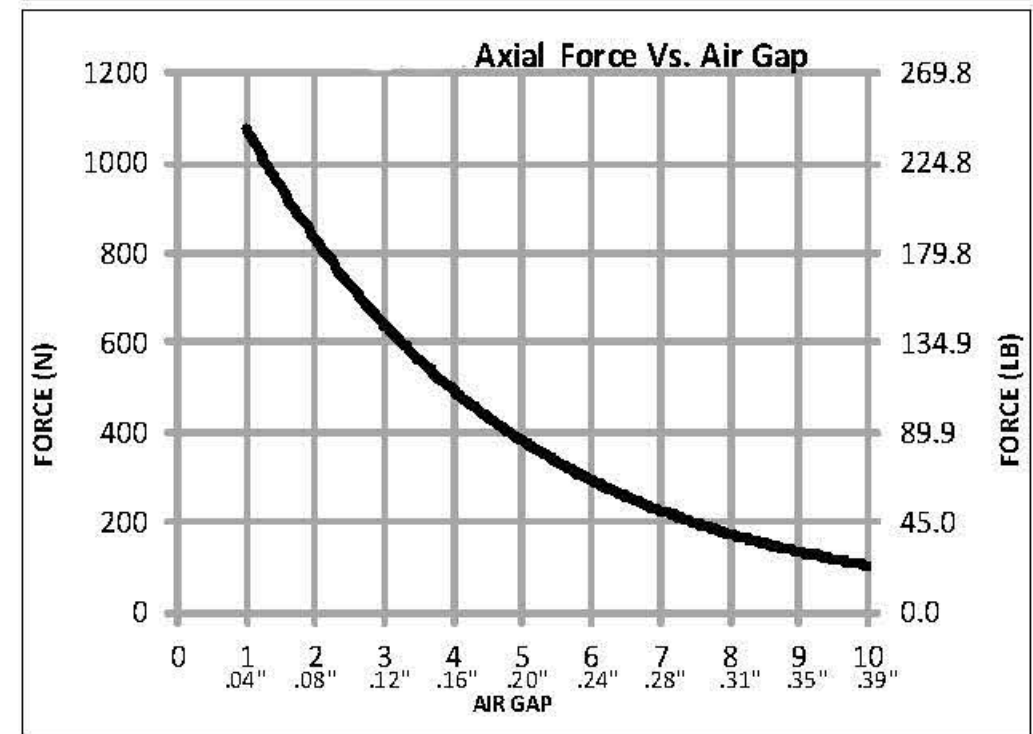
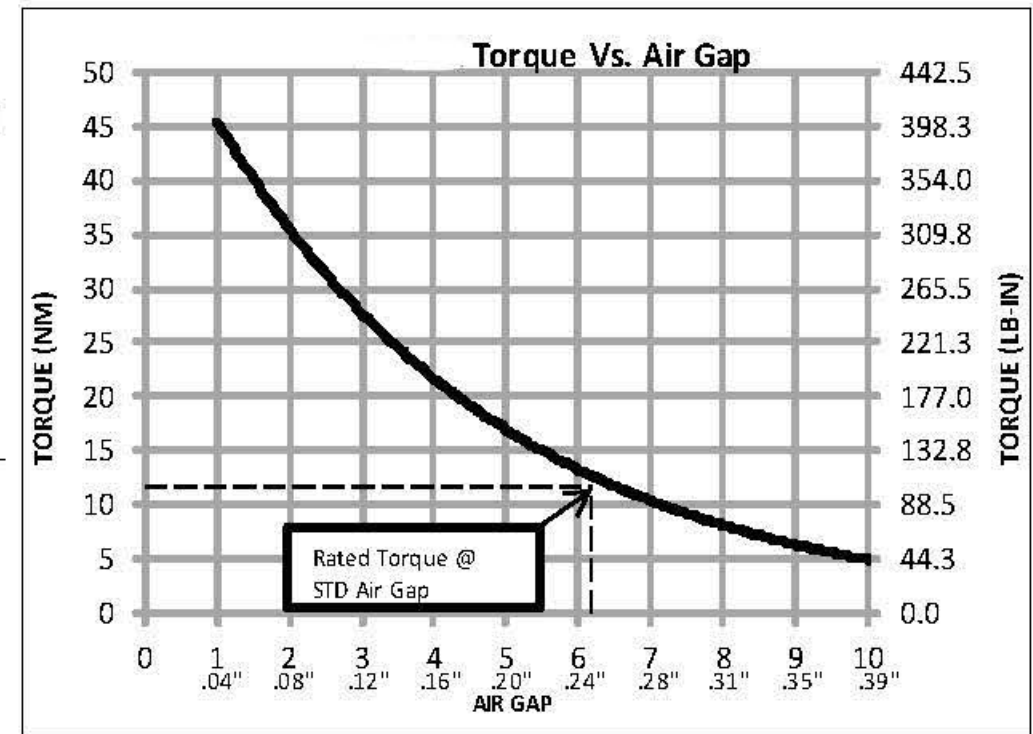
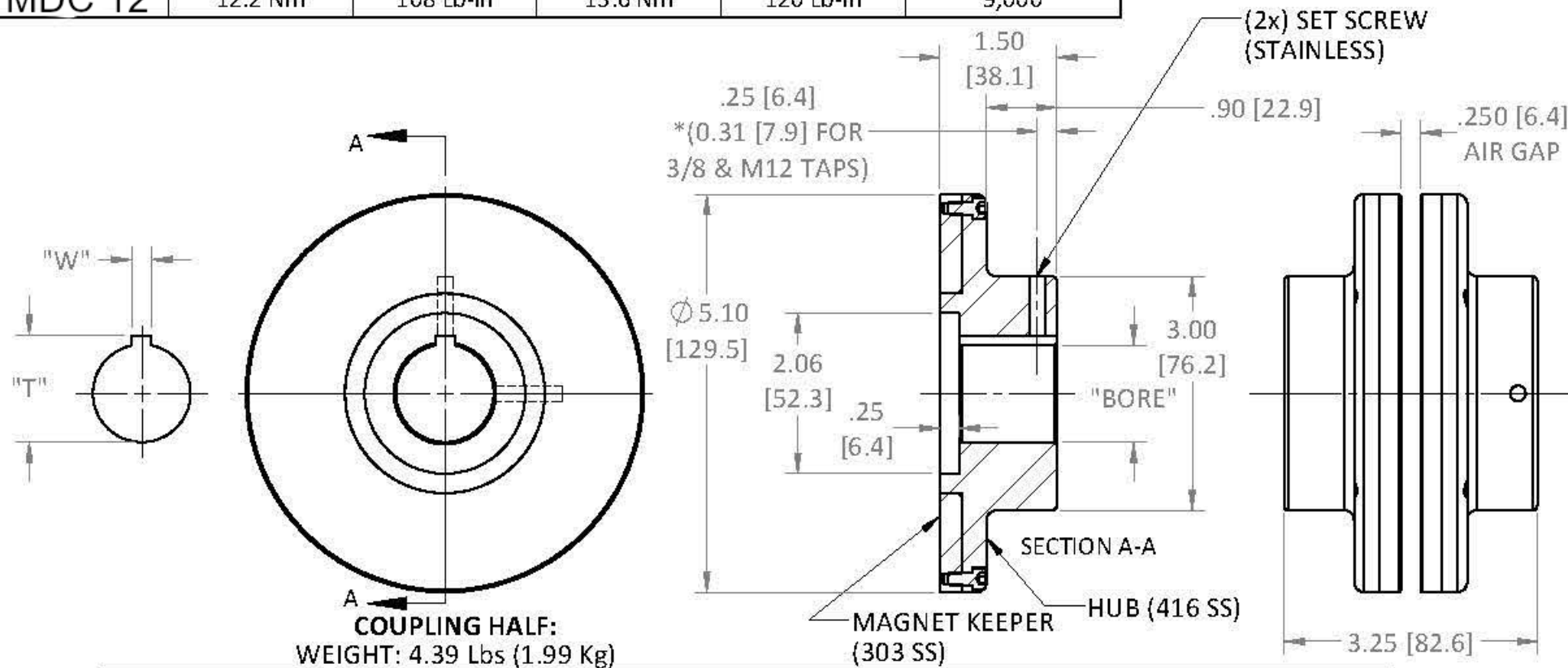

MODEL	BORE		W		T		SET SCREW (2x)
	mm <sup>H8</sup>	in <sup>+0.001</sup>	mm <sup>+0.05</sup>	in <sup>+0.002</sup>	mm <sup>+0.25</sup>	in <sup>+0.010</sup>	
MDC 12							CUP POINT
*	SOLID		-		-		-
	14.00	.551	5.00	.1969	16.30	.642	M5-0.8 x 20mm
	15.88	.625	4.76	.1875	18.00	.709	#10-32 x 3/4
	18.00	.709	6.00	.2362	20.80	.819	M5-0.8 x 20mm
	19.00	.748	6.00	.2362	21.80	.858	M5-0.8 x 20mm
	19.05	.750	4.76	.1875	21.26	.837	#10-32 x 3/4
	20.00	.7874	6.00	.2362	22.80	.898	M5-0.8 x 20mm
	22.23	.875	4.76	.1875	24.49	.964	#10-32 x 3/4
	24.00	.945	8.00	.3150	27.30	1.075	M8-1.25 x 20mm
	25.4	1.000	6.35	.250	28.30	1.114	1/4-20 x 5/8
	28.00	1.102	8.00	.3150	31.30	1.232	M8-1.25 x 20mm
	28.58	1.125	6.35	.250	31.52	1.241	1/4-20 x 5/8
	31.75	1.250	6.35	.250	34.72	1.367	1/4-20 x 5/8
	34.93	1.375	7.94	.3125	38.56	1.518	5/16-18 x 1/2
	38.1	1.500	9.53	.375	42.39	1.669	3/8-16 x 1/2*
	41.28	1.625	9.53	.375	45.62	1.796	3/8-16 x 1/2*
	42.00	1.654	12.00	.472	45.30	1.783	M12-1.75 x 12mm*

OTHER SIZES AVAILABLE; SPECIFY BOTH BORE AND KEYWAY  
\* FROM STOCK

USED ON	SCALE 1:2	MATERIAL SEE PRT DWG	DESCRIPTION  <b>Cut Sheet</b>
UNLESS OTHERWISE SPECIFIED:		FINISH SEE PRT DWG	
ALL DIMENSIONS ARE IN INCHES TOLERANCES: DECIMAL: JX ± .01 - JXXX ± .005 ANGULAR: ± 1° GEN. CONCENTRICITY: .001 T.I.R. MACH. FILLETS: .010 R MACH. EDGES: .015 R OR CHMF. UNSPECIFIED RADII: .015 R IN MICROINCHES RMS 32 GEOMETRIC: TO MIL-ST'D. 8 REMOVE ALL BURRS & SHARP EDGES		DRAWN AMD 11/11/14	
		CHECKED	
		SIZE: B	DWG. NO.
			REV.